

JOINTS & SADDLES

# MECHANICAL JOINT FOR DI PIPE

COUPLING & FLANGE ADAPTOR



**MECHANICAL COUPLING**

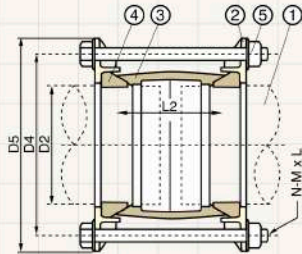

No.	Component
1	Pipe
2	Gland
3	Sleeve
4	Rubber Gasket
5	Bolt and Nut

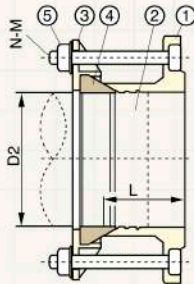

No.	Component
1	Sleeve
2	Pipe
3	Gland
4	Rubber Gasket
5	Stud Bolt



**MECHANICAL FLANGE ADAPTOR**

JOINTS & SADDLES

# MECHANICAL JOINT FOR DI PIPE | COUPLING & FLANGE ADAPTOR

No.	Component	Material	Standard Ref.
1	Bolt & Nut	Hot Dipped Galvanized	BS 4190
2	Sleeve	Ductile Iron (EN-GJS-500-7)	BS EN 1563
3	Gland	Ductile Iron (EN-GJS-500-7)	BS EN 1563
4	Rubber Gasket	EPDM	BS EN 681
5	Coating	Fusion Bonded Epoxy	-

**MECHANICAL COUPLING**

Dimension in mm

DN	D2	D4	D5	L2	M	N	L
80	98	158	188	100	1/2"	4	175
100	118	182	212	100	1/2"	4	175
150	170	237	267	100	1/2"	4	175
200	222	292	322	100	1/2"	4	175
250	274	345	375	100	1/2"	6	175
300	326	396	426	100	1/2"	6	175
350	378	460	498	150	5/8"	8	230
400	429	515	553	150	5/8"	8	230
450	480	565	603	150	5/8"	10	230
500	532	620	658	150	5/8"	10	230
600	635	725	763	150	5/8"	10	230
700	738	840	878	150	5/8"	12	230
800	842	950	988	150	5/8"	12	230

**MECHANICAL FLANGE ADAPTOR**

Dimension in mm

DN	D2	n	M	L	Flange Standard
80	98	4	1/2"	70	PN10+PN16 + TABLE E
100	118	4	1/2"	70	PN10+PN16 + TABLE E
150	170	4	1/2"	75	PN10+PN16 + TABLE E
200	222	4	1/2"	75	PN10+PN16 + TABLE E
250	274	6	1/2"	90	PN10+PN16 + TABLE E
300	326	6	1/2"	90	PN10+PN16 + TABLE E
350	378	8	1/2"	100	PN16
400	429	8	1/2"	100	PN16
450	480	10	1/2"	100	PN16
500	532	10	1/2"	100	PN16
600	635	10	1/2"	100	PN16
700	738	12	1/2"	100	PN16
800	842	12	1/2"	100	PN16

Please Note: Technical data provided is indicative only and may be subject to change without notice



LVE MANUFACTURING SDN. BHD. 02836-10  
 Manufacturer of Valves, Hydrants, Joints, Fittings & Manhole Covers.



LVE MANUFACTURING SDN. BHD. 02836-10  
 Manufacturer of Valves, Hydrants, Joints, Fittings & Manhole Covers.

