

## JOINTS & SADDLES

# UNI-FLANGE



### FEATURES:

- LYE Ductile Iron Uni-Flange Adaptor is ideal on ductile iron and mild steel pipe where retro-fitting at job site is required.
- Pipe flanging can be easily fabricated on site using plain end pipe without the need of any special tools and the flange restraint is provided by means of a set screw locking device.
- Uses EPDM wedge-rubber gasket for seal.
- Bolt hole drilling is to BS EN 1092-2 PN 16.
- Can be used for above or below ground application.
- Can be disassembled for maintenance if required.

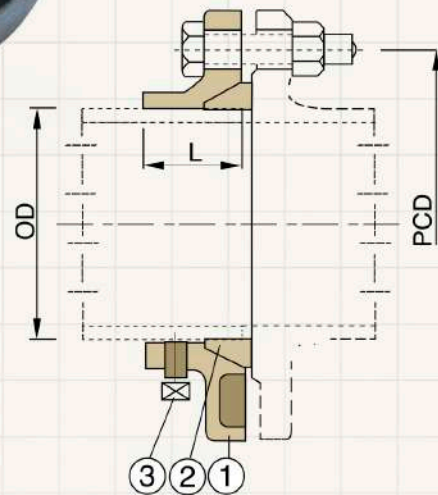

No.	Component	Material
1	Adaptor	Ductile Iron
2	Rubber Ring	EPDM
3	Set Bolts	Steel with Hot Dipped Galvanized

DN	Pipe OD		L
	DI Pipe	Steel Pipe	
80	98	88.9	50
100	118	114.3	50
150	170	168.3	50
200	222	219.1	59
250	274	273	61
300	326	323.9	63
350	378	-	65
400	429	-	67

Please Note: Technical data provided is indicative only and may be subject to change without notice



LYE MANUFACTURING SDN. BHD. (32836-H)  
 Manufacturer of Valves, Hydrants, Joints, Fittings & Manhole Covers.

