



FLEXIBLE

MECHANICAL JOINTS FOR DUCTILE IRON PIPE

SOLUTION OF HIGH INSTALLATION FLEXIBILITY

Mechanical Coupling



Mechanical Flange Adaptor

Flange Dismantling Joint

Mechanical Coupling

Mechanical Flange Adaptor

Flange Dismantling Joint

In Brief

- ▶ For Connecting DI Pipe & Other Rigid Pipe Material with Similar OD
- ▶ Ideal for Quick & Easy Pipeline Repair, Maintenances & System Servicing

- ▶ For Longitudinal Adjustment With Telescoping Action of Flanged Spigot

- ▶ Working Pressure : PN16
- ▶ Coating : Fusion Bonded Epoxy
- ▶ Sealing : EPDM
- ▶ Angular Deflection : $\pm 3^\circ$
- ▶ Longitudinal Adjustment : Up to 50mm/2"

Standards

- ▶ Design : SPESIFIKASI JKR 20200-0048-99
- ▶ Test : EN 12266-1
- ▶ Flange : EN 1092-2
- ▶ For Ductile Iron Pipe : BS EN 545 / BS EN 598 / ISO 2531 / MS 1919 / DIN 28601
- ▶ For Mild Steel Pipe (\leq DN300) : BS 534 / SPAN TS 21827 / AS 1579

Features

- ▶ Range of Coupling Sizes : DN80 to DN800
- ▶ Range of Flange Sizes : DN100 to DN150
- ▶ Allowing Length Locking with Tie Bars Supplied
- ▶ Wedge Gasket Type Allowing OD Tolerance (+1-3)mm for Water Sealing
- ▶ For Limited Ground Movement, Expansion, Contraction and Minor Angular Misalignment of Pipeline
- ▶ Long Collar with 225mm Body Sleeve for Better Prevention of Pipe-Pull Out



LYE MANUFACTURING SDN.BHD. (197701001852 (32836-H))
 Manufacturer of Valves, Hydrants, Joints, Fittings & Manhole Covers

MECHANICAL JOINTS FOR DUCTILE IRON PIPE

SOLUTION OF HIGH INSTALLATION FLEXIBILITY

Technical Table

Mechanical Coupling

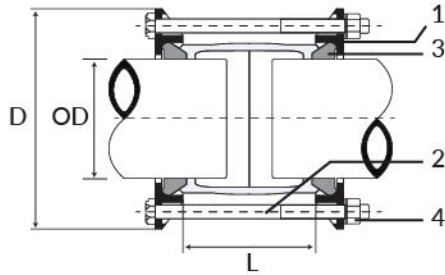

Assembly Chart

No.	Component	Material	Standard Ref.
1	Gland Flange	Ductile Iron	BS EN 1563
2	Sleeve/Collar	Ductile Iron	BS EN 1563
3	Gasket	EPDM	BS EN 681
4	Bolt & Nut	Hot Dipped Galvanized	BS EN 4190

Specifications & Parameters Chart

DN (mm)	OD (mm)	D (mm)	L (mm)	Bolts
80	98	188	100/225	M12x4
100	118	212	100/225	M12x4
150	170	267	100/225	M12x4
200	222	322	100/225	M12x4
250	274	375	100/225	M12x6
300	326	426	100/225	M12x6
350	378	498	150/225	M16x8
400	429	553	150/225	M16x8
450	480	603	150	M16x10
500	532	658	150	M16x10
600	635	763	150	M16x10
700	738	878	150	M16x12
800	842	988	150	M16x12

Mechanical Flange Adaptor

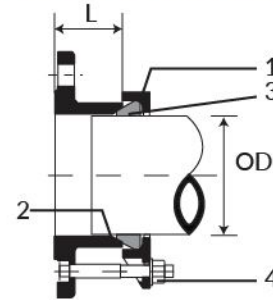

Assembly Chart

No.	Component	Material	Standard Ref.
1	Gland Flange	Ductile Iron	BS EN 1563
2	Body	Ductile Iron	BS EN 1563
3	Gasket	EPDM	BS EN 681
4	Bolt & Nut	Hot Dipped Galvanized	BS EN 4190

Specifications & Parameters Chart

DN (mm)	OD (mm)	L (mm)	Bolts	Flange Standard
80	98	70/225	M12x4	PN10+PN16+BS10/E+ANSI/150
100	118	70/225	M12x4	PN10+PN16+BS10/E+ANSI/150
150	170	75/225	M12x4	PN10+PN16+BS10/E+ANSI/150
200	222	75/225	M12x4	PN10+PN16+BS10/E+ANSI/150
250	274	90/225	M16x6	PN10+PN16+BS10/E+ANSI/150
300	326	90/225	M16x6	PN10+PN16+BS10/E+ANSI/150
350	378	100/225	M16x8	PN10/PN16
400	429	100/225	M16x8	PN10/PN16
450	480	100	M16x10	PN10/PN16
500	532	100	M16x10	PN10/PN16
600	635	100	M16x10	PN10/PN16
700	738	100	M16x12	PN10/PN16
800	842	100	M16x12	PN10/PN16

Flange Dismantling Joint

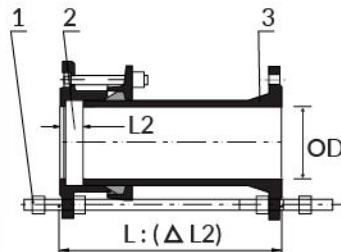

For Fast & Simple Axial Movement of Water Metering System

Assembly Chart

No.	Component	Material	Standard Ref.
1	Tie Rod Bar	Galvanized Steel	BS EN 4190
2	Mech. Flange Adaptor	Ductile Iron	BS EN 1563
3	Flanged Spigot	Ductile Iron	BS EN 1563

Specifications & Parameters Chart

DN (mm)	OD (mm)	L (mm)	L2 (mm)
100	118	300	50
150	170	450	50

Note: Technical data provided in this brochure is indicative only and may be subject to change without prior notice.