

**LYE**

RESTRAINT

# PUSH-ON JOINT RESTRAINT HARNESS

FOR RESTRAINING OF DI SOCKET PUSH-ON JOINTS



Model : 789



## In Brief

- ▶ For Restraining of Ductile Iron Socket Push-on Joints against Longitudinal Socket Joint Separation
- ▶ With Added Security by Friction Clamps with Tie-Rods
- ▶ **Working Pressure** : PN10/PN 16
- ▶ **Coating** : Fusion Bonded Epoxy

## Standards

- ▶ **Test** : EN 12266-1
- ▶ **For Ductile Iron Pipe** : BS EN 545 / BS EN 598 / ISO 2531 / MS 1919

## Features

- ▶ **Range of Push-On Joint Restraint Harness Sizes** : DN80 - DN300
- ▶ For System Applications for Unbalanced Forces of Hydrostatic or Hydrodynamic Causing Joint Separation
- ▶ Ideal for Underground & Aboveground Pipeline Installation
- ▶ Commonly Used in By-Pass Pipeline, Difference in Height, Internal Forces Raised by Pressure & Bridge Crossing



**LYE MANUFACTURING SDN.BHD.** (197701001852 (32836-H))  
Manufacturer of Valves, Hydrants, Joints, Fittings & Manhole Covers

# PUSH-ON JOINT RESTRAINT HARNESS FOR RESTRAINING OF DI SOCKET PUSH-ON JOINTS

## Technical Table

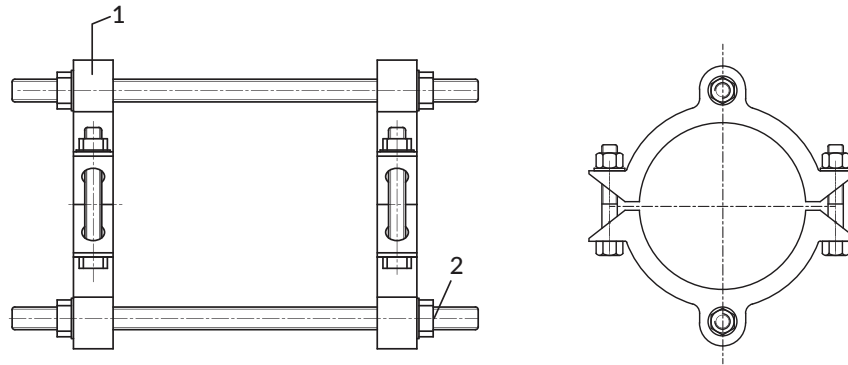

## Assembly Chart

No.	Component	Material	Standard Ref.
1	Restraint Ring	Ductile Iron	BS EN 1563
2	Bolts & Nuts	Hot Dipped Galvanized	BS 4190

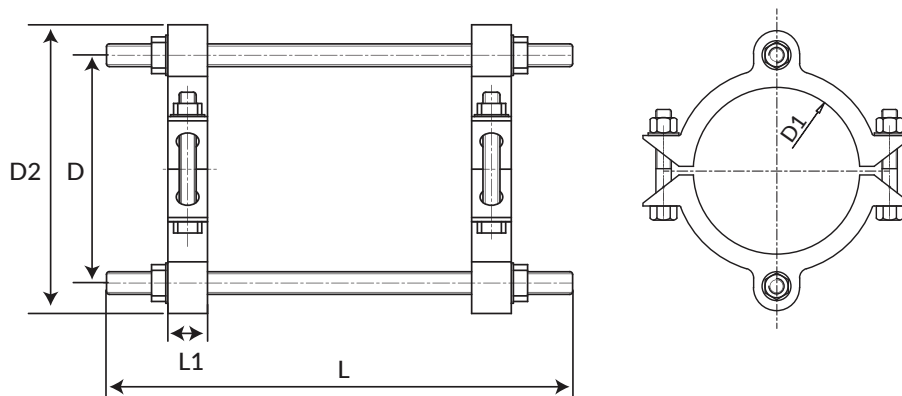

## Specifications & Parameters Chart

### Jointing Assembly



DN (mm)	D (mm)	D2 (mm)	D1 (mm)	L (mm)	L1 (mm)	Bolts
80	161	204	98	280	28	M16x2
100	184	227	118	290	28	M16x2
150	240	291	170	310	28	M20x2
200	301	352	222	320	28	M20x2
250	360	412	274	330	30	M20x4
300	417	469	326	345	32	M20x4

Note: Technical data provided in this brochure is indicative only and may be subject to change without prior notice.



### LYE MANUFACTURING SDN.BHD. (197701001852 (32836-H))

Manufacturer of Valves, Hydrants, Joints, Fittings & Manhole Covers

Lot 1844, Jalan KPB 8, Kampung Baru Balakong, 43300 Kajang, Selangor Darul Ehsan, Malaysia.

FACTORY Tel: 603 - 8961 1623 Fax: 603 - 8961 1092 EMAIL: enquiry@lye.com.my

SALES Tel: 603 - 6140 3131(Hunting Line) Fax: 603 - 6140 5858

Scan For More Info

